

LOT C 103

R+1

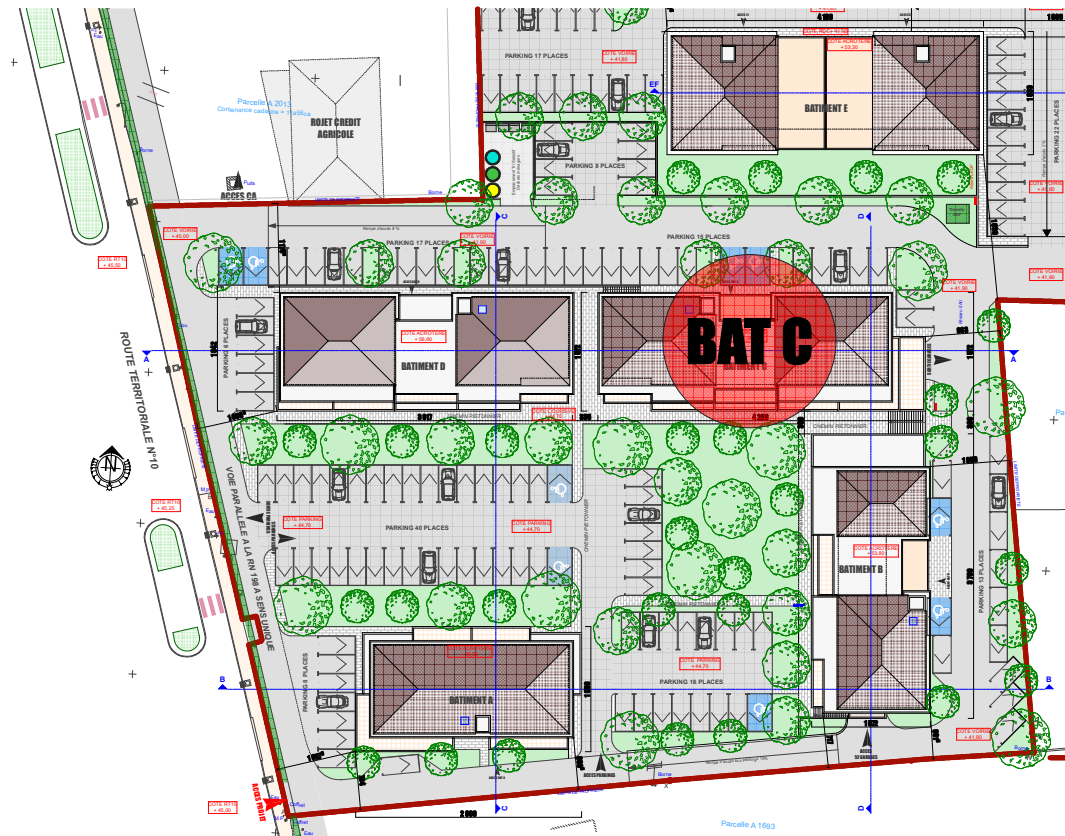

Plan de Masse

T2

C 103

Dgt	1,51 m ²
Séjour/Cuisine	23,20 m ²
Chambre 1	11,66 m ²
SdB	6,63 m ²

TOTAL surface habitable **43,00 m²**

Terrasse 18,17 m²



Plan d'étage courant R+1

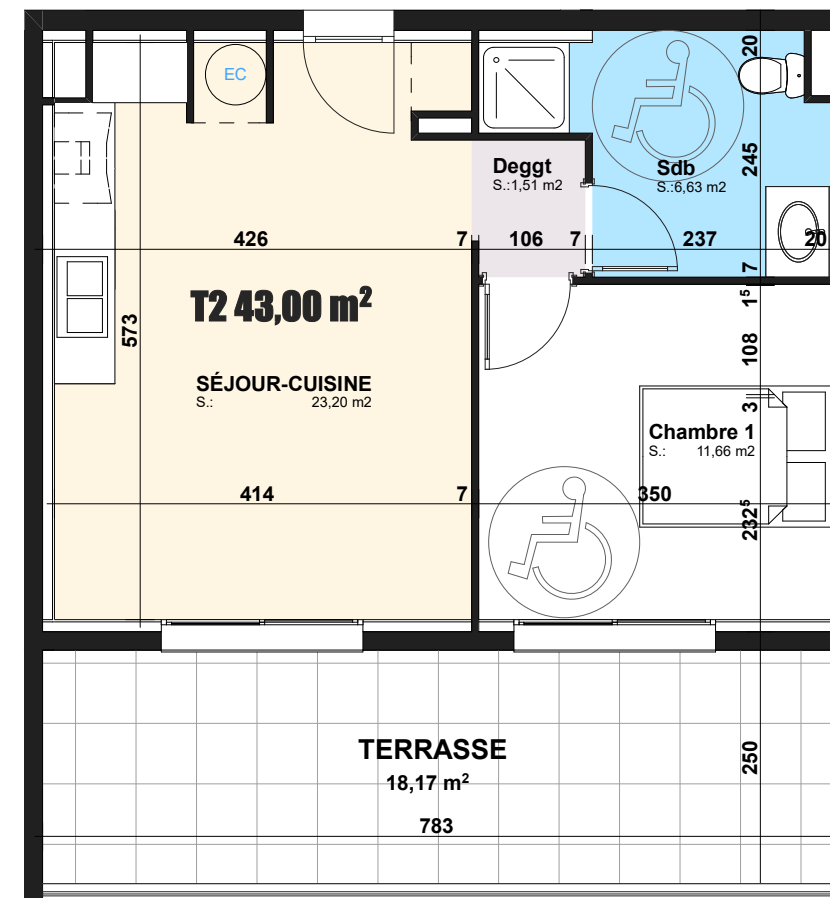

commune de PENTA DI CASINCA

Résidence U Centru